

Cleveland

Wheels & Brakes

Parker Hannifin Corporation

Aircraft Wheel & Brake

1160 Center Road, P.O. Box 158

Avon, Ohio 44011 USA

1-800-BRAKING (272-5464)

216-937-1272 • FAX 216-937-5409

PRODUCT REFERENCE MEMO

INSPECTION OF 151-01700 AND 152-03400 WHEEL HALVES USED IN THE 40-102, 40-102A, 40-130 AND 40-196 WHEEL ASSEMBLIES

- PURPOSE:** To advise owners of Cleveland Wheel and Brake Assemblies 40-102, 40-102A, 40-130 and 40-196, that grooves may develop on the inside hub faces of both wheel halves. (See Figure 1.)
- INSPECTION PROCEDURE:** Within the next 100 hours and at periodic maintenance inspections, visually inspect the inside hub faces of both wheel halves for circular groove wear.
- ACCEPTANCE:** If both hub faces are free of any excessive grooves greater than .006" in depth, the wheel halves are acceptable for continued use.
- REJECTION:** If groove wear between .002" - .006" are found on any of the two hub faces, replace the 067-01400 spacer with a new configuration 067-12000 spacer. The 067-12000 spacer is painted white for identification purposes. If the grooves exceed .006" in depth, replace the 151-01700 and 152-03400 wheel halves.

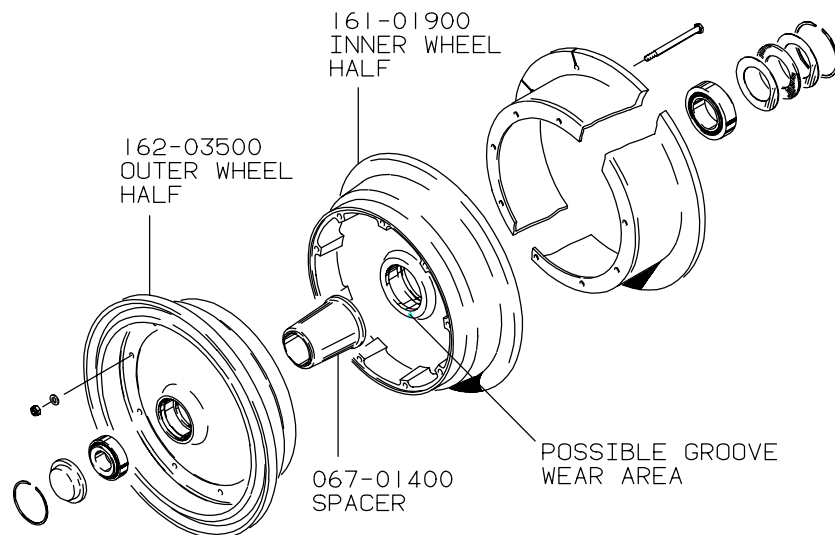

Figure 1
Wheel Inspection