

40-117A

Tube-Type

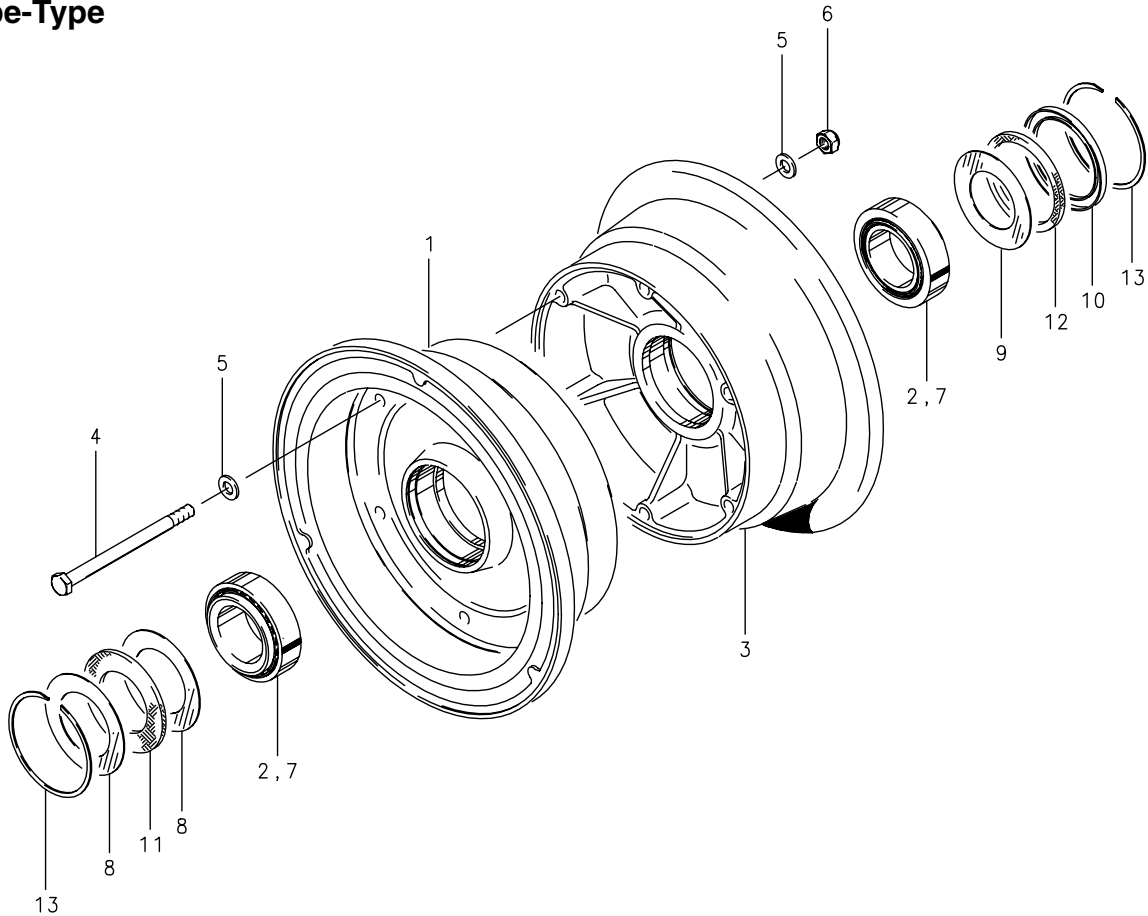

Assy. Number

A) 40-117A

FIG.	PART NUMBER	DESCRIPTION	QTY. PER ASSY.
			A
1	161-02300	Inner Wheel Half Assy.	1
2	214-00100	Cup-Bearing	1
3	162-04800	Outer Wheel Half Assy.	1
2	214-00100	Cup-Bearing	1
4	103-20400	Bolt (AN5-35A)	6
5	095-10500	Washer (AN960-516)	12
6	094-10400	Nut (MS21044-N5)	6
7	214-00200	Cone-Bearing	2
8	153-00400	Ring-Grease Seal	2
9	153-00300	Ring-Grease Seal	1
10	153-01500	Ring-Grease Seal	1
11	154-00300	Felt-Grease Seal	1
12	154-01300	Felt-Grease Seal	1
13	155-00100	Snap Ring	2

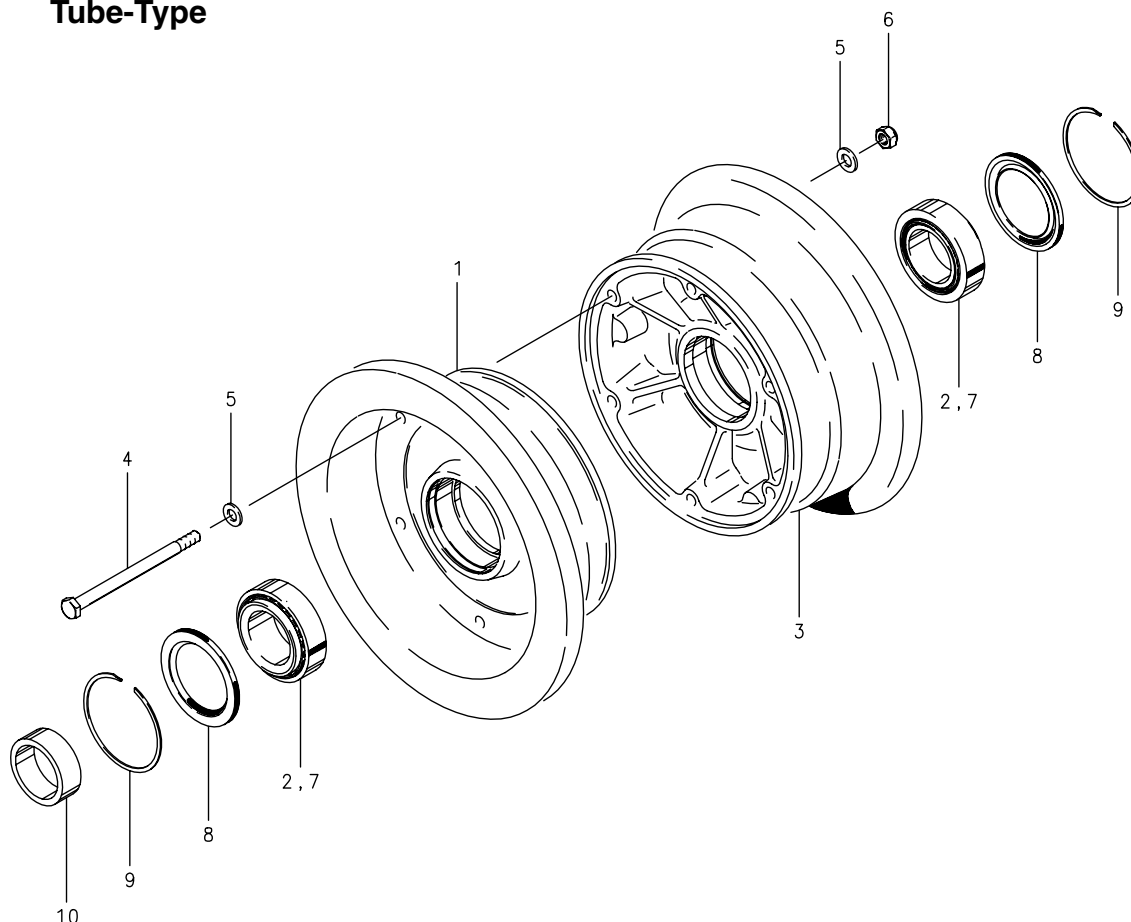
**Illustrated Parts List****Wheel Assembly – Nose****7.00-8****40-177A, 40-193****Tube-Type****Assy. Number****A) 40-177A****B) 40-193**

FIG.	PART NUMBER	DESCRIPTION	QTY. PER ASSY.	
			A	B
1	161-06402	Inner Wheel Half Assy.		1
	161-11700	Inner Wheel Half Assy.	1	
2	214-00100	Cup-Bearing	1	1
3	162-06002	Outer Wheel Half Assy.		1
	162-10700	Outer Wheel Half Assy.	1	
2	214-00100	Cup-Bearing	1	1
4	103-20400	Bolt (AN5-35A)	6	6
5	095-10500	Washer (AN960-516)	12	12
6	094-10400	Nut (MS21044-N5)	6	6
7	214-00200	Cone-Bearing	2	2
8	154-03000	Molded Grease Seal	2	
	154-03600	Molded Grease Seal		2
9	155-00100	Snap Ring	2	2
10	067-07000	Spacer-Axle		1

**Cleveland**  
 Wheels & Brakes
